

## 适用范围 Application

DZ电动机起动器是一种可靠和节约成本的电动机保护方案。它具有非常广泛的应用场合。一般应用于工程和工厂、工业系统、传送带系统、化学工业包括过程处理、药品工业、建筑自动化(如空调系统)、环保工厂、电厂、净水及污水处理、机床工业等。额定电流由0.1A至100A。可对电机和线路进行高效可靠的过载、短路、断相及欠压保护。

DZ motor starter is a reliable and cost saving motor protection scheme. It has a very wide range of applications. Generally used in transmission engineering and plant, industrial system, belt system, chemical industry, pharmaceutical industry, including the process of building automation (such as air conditioning systems), environmental protection factory, power plant, water purification and sewage treatment, machine tool industry etc.. Rated current from 0.1A to 100A. High efficient and reliable overload, short circuit, broken phase and under voltage protection of motor and circuit.

## 型号及命名 Model and name

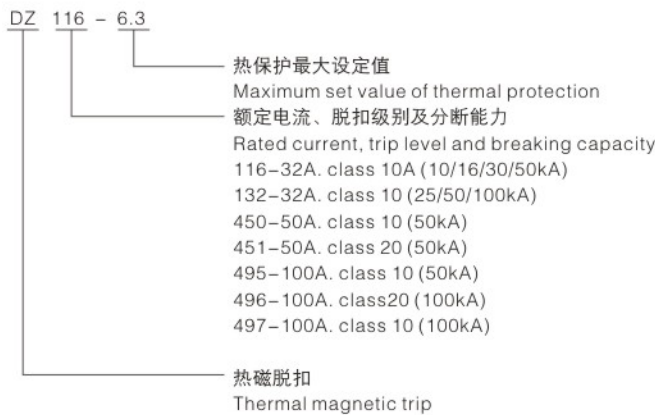

## 脱扣曲线图 Trip Diagram

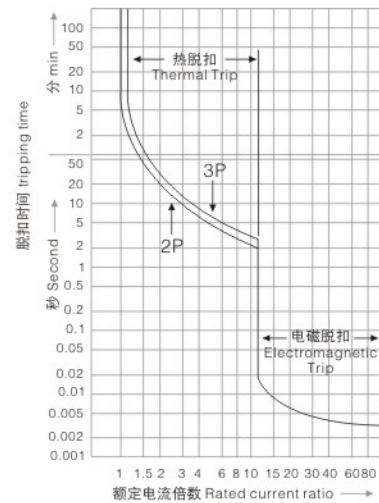

## 技术参数 Specifications

型号 type		Dz116	Dz132	DZ450/451	DZ495/496/497
额定绝缘电压 Rated insulation voltage $U_i$	IEC EN 60947 VAC	690			
	CSA/UL/NEMA VAC	600			
额定工作电压 Rated operating voltage $U_e$	V	690AC			
额定冲击耐受电压 Rated impulse withstand voltage $U_{imp}$	KV	6			
额定工作电流 Rated operating current $I_e$	A	32A	32A	50A	100A
额定持续发热电流 Rated continuous heating current $I_{th}$	A	32A	32A	50A	100A
额定频率 Rated frequency	Hz	50/60			
电流设定范围 Current setting range $I_e$	A	0.1~32	0.1~32	11~50	28~100
短路分断能力 Short to the breaking capacity $I_e$	400V	Max50kA	Max100kA	Max50kA	Max100kA

## 技术参数 Specifications

型号 type	电流整定范围 A...A Current setting range	短路分断能力 I <sub>cu</sub> 400V AC, kA Short circuit breaking capacity	额定瞬时短路电流 A Rated instantaneous short circuit current
DZ116-0.16	0.10... 0.16	50	1.25...1.87
DZ116-0.25	0.16... 0.25	50	1.95...2.92
DZ116-0.4	0.25... 0.40	50	3.12...4.68
DZ116-0.63	0.40... 0.63	50	4.91...7.37
DZ116-1.0	0.63... 1.00	50	9.20...13.8
DZ116-1.6	1.00... 1.60	50	14.7...22.1
DZ116-2.5	1.60... 2.50	50	23.0...34.5
DZ116-4.0	2.50... 4.00	50	40.0...60.0
DZ116-6.3	4.00... 6.30	50	63.0...94.5
DZ116-10	6.30... 10.0	50	120...180
DZ116-12	8.00... 12.0	25	144...216
DZ116-16	10.0... 16.0	16	192...288
DZ116-20	16.0... 20.0	15	240...360
DZ116-25	20.0... 25.0	15	300...460
DZ116-32	25.0... 32.0	10	384...576

## 外形安装尺寸 The external fixing dimension

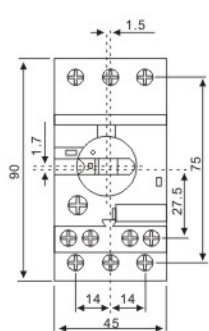

DZ116 ≤ 16A

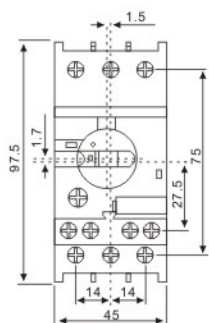

DZ116 ≥ 20A

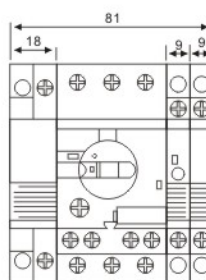
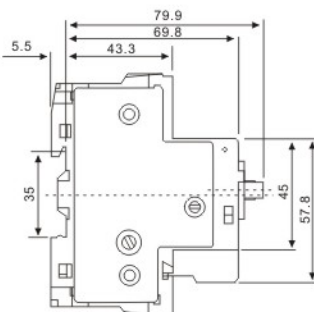
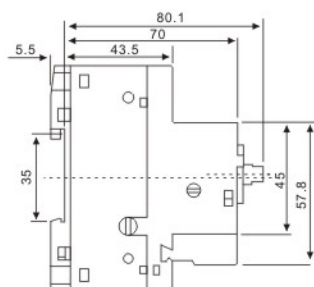

DZ116+UA1, AA1, SK1, HK1, CK1, HKF1-11

